

# CONTEST 46



*Contest*





# CONTEST 46

## TECHNICAL SPECIFICATIONS

design Dick Zaai



Contest yachts are built according to Lloyd's rules

length o.a.	14.14 m	46' - 5"
length w.l.	11.85 m	38' - 11"
beam	4.20 m	13' - 9"
draft winged keel	1.70 m	5' - 7"
draft bulb keel	1.95 m	6' - 5"

ballast	6.200 kg	13668 lbs
displacement	15.400 kg	33960 lbs
fuel	600 l	132 imp. gallons
fresh water	800 l	176 imp. gallons
engine	74kw/100 HP	Volvo Per a

	Sloop	
mastheight above waterline	19.80 m	64' - 4"
mainsail	42.83 m <sup>2</sup>	460 sq.ft.
genoa I	78.68 m <sup>2</sup>	845 sq.ft.
genoa II	58.31 m <sup>2</sup>	627 sq.ft.
spinnaker	177.00 m <sup>2</sup>	1902 sq.ft.

	Ketch	
mastheight above waterline	18.63 m	61' - 2"
mainsail	35.45 m <sup>2</sup>	381 sq.ft.
mizzen	15.94 m <sup>2</sup>	171 sq.ft.
genoa I	64.50 m <sup>2</sup>	693 sq.ft.
genoa II	50.22 m <sup>2</sup>	540 sq.ft.
mizzenstaysail	34.43 m <sup>2</sup>	370 sq.ft.
spinnaker	144.61 m <sup>2</sup>	1555 sq.ft.



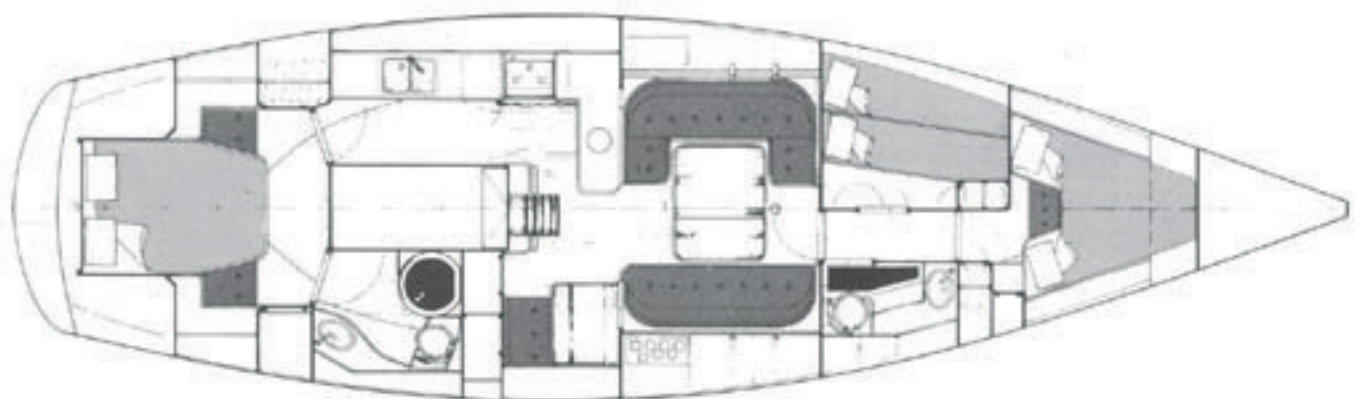
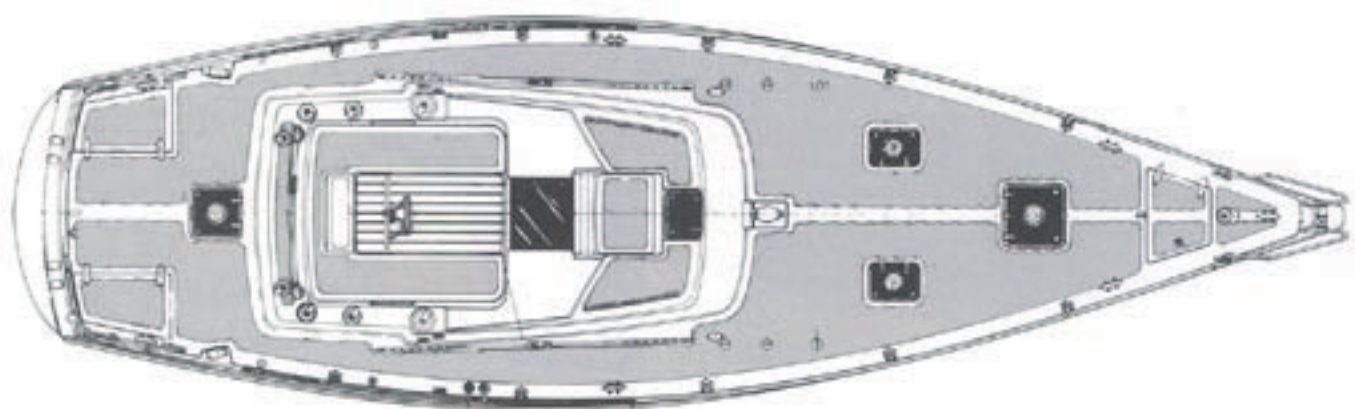
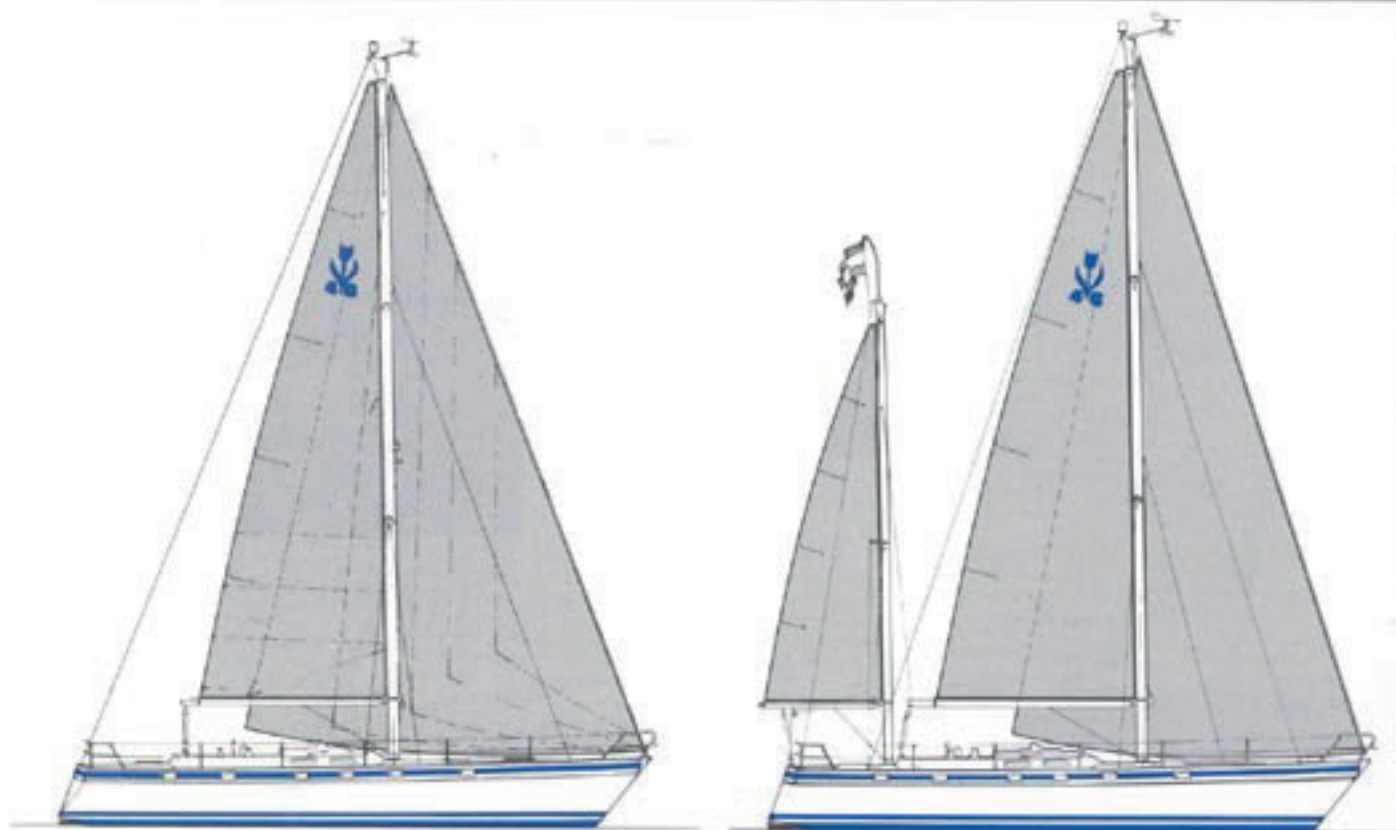

**Conyplex b.v.**, Overleek 3, 1671 GD Medemblik, Holland, ☎ 02274-3644, Telefax 02274-3648

